



The latest skid steer loader by LOCUST has over 30 years of experience backing it. LOCUST is the direct successor of the loader UNC produced by the same manufacturer with many years of experience, development and tradition combined to make this new loader.



L 753

since the first products by UNC were introduced in 1981, the skid steer front loader manufactured in

Slovakia has undergone many years of development culminating into today's LOCUST loaders. These loaders have been certified by testing and have proven themselves in a variety of practical applications (construction, agriculture, winter maintenance of roads and car parks) in many countries and under different weather and terrain conditions.

Combining years of experience and feedback from our satisfied clients, LOCUST is able to improve on the high-quality components such as engine, hydrostatic drive and construction design, offering high work efficiency and the most favourable price/performance ratio in its class.

Because of its dimensions and characteristics, it is highly flexible and easily manoeuvrable making it ideal for narrow and confined spaces. It is especially suitable for the agricultural sector and municipalities.

LOADER FEATURES

- low operating expenses
- high work efficiency
- easy operation
- high comfort
- unrivalled view from the cabin
- simple servicing and maintenance
- unobstructed accessibility of parts and components
- standard and ISO connection of attachments
- a gearbox with gear drives that has proved itself over time by use
- long lifespan



WAY INDUSTRIES, a.s.
Priemyselná 937/4, 963 01 Krupina, SLOVAKIA

Tel: +421 45 5501 402
E-mail: info@way.sk



Locust L753



DIMENSIONS

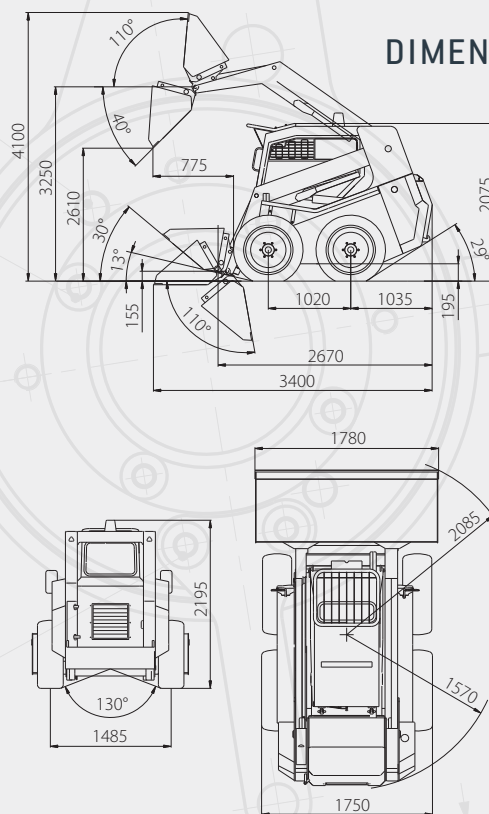

TECHNICAL PARAMETERS

L753

Loader height	2,075 mm
Loader length with bucket	3,400 mm
Loader width with bucket	1,780 mm
Operating weight	3,180 kg
Tipping load	750 kg
Maximum speed	8 – 15 km/h
Bucket volume	0.43 m ³
Breakout force	25 kN
Tractive force	31.5 kN
Lifting force	19 kN
Engine type	YANMAR 4TNV 88 BDWI
Power	36.5 kW/49.6 HP
Drive type	hydrostatic
Hydraulic pump of the working equipment	constant
Distributor of working equipment	with open centre
Bucket balancing	hydraulic
Noise	101 dB
Standard tyres	10 – 16.5



Authorised business representative



The latest skid steer loader by LOCUST has over 30 years of experience backing it. LOCUST is the direct successor of the loader UNC produced by the same manufacturer with many years of experience, development and tradition combined to make this new loader.



L 903

since the first products by UNC were introduced in 1981, the skid steer front loader manufactured in Slovakia has undergone many years of development culminating into today's LOCUST loaders. These loaders have been certified by testing and have proven themselves in a variety of practical applications (construction, agriculture, winter maintenance of roads and car parks) in many countries and under different weather and terrain conditions.

Combining years of experience and feedback from our satisfied clients, LOCUST is able to improve on the high-quality components such as engine, hydrostatic drive and construction design, offering high work efficiency and the most favourable price/performance ratio in its class.

The loader is most attractive thanks to the price/performance ratio and low operating expenses.

LOADER FEATURES

- low operating expenses
- high work efficiency
- easy operation
- high comfort
- unrivalled view from the cabin
- simple servicing and maintenance
- unobstructed accessibility of parts and components
- standard and ISO connection of attachments
- highly flexible and easily manoeuvrable
- a gearbox with gear drives that has proved itself over time by use
- long lifespan



WAY INDUSTRIES, a.s.
Priemyselná 937/4, 963 01 Krupina, SLOVAKIA

Tel: +421 45 5501 402
E-mail: info@way.sk



Locust

L903 Eco

L903

L903 Speed



DIMENSIONS

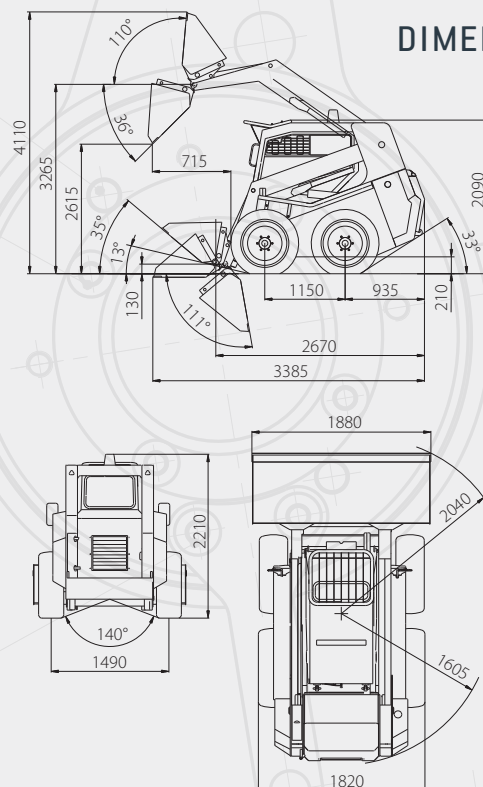

TECHNICAL PARAMETERS

	L903 ECO	L903	L903 SPEED
Loader height	2,090 mm	2,090 mm	2,090 mm
Loader length with bucket	3,385 mm	3,385 mm	3,385 mm
Loader width with bucket	1,880 mm	1,880 mm	1,880 mm
Operating weight	3,460 kg	3,500 kg	3,500 kg
Tipping load	912 kg	960 kg	960 kg
Maximum speed	8.5 – 17 km/h	14 km/h	12 - 24 km/h
Bucket volume	0.43 m ³	0.43 m ³	0.43 m ³
Breakout force	25 kN	28 kN	28 kN
Tractive force	34 kN	32 kN	39 kN
Lifting force	17.9 kN	19.5 kN	19.5 kN
Engine type	YANMAR 4TNV 88 BDWI	YANMAR 4TNV 98 ZNWI	YANMAR 4TNV 98 ZNWI
Power	36.5 kW/49.6 HP	52.1 kW/71 HP	52.1 kW/71 HP
Drive type	hydrostatic	hydrostatic	hydrostatic
Hydraulic pump of the working equipment	constant	regulatory – LS/LUDV	regulatory – LS/LUDV
Distributor of working equipment	with open centre	with closed centre	with closed centre
Bucket balancing	hydraulic	hydraulic	hydraulic
Noise	101 dB	101 dB	101 dB
Standard tyres	12 – 16.5	12 – 16.5	12 – 16.5

Authorised business representative



The latest skid steer loader by LOCUST has over 30 years of experience backing it. LOCUST is the direct successor of the loader UNC produced by the same manufacturer with many years of experience, development and tradition combined to make this new loader.



L 1203 since the first products by UNC were introduced in 1981, the skid steer front loader manufactured in Slovakia has undergone many years of development culminating into today's LOCUST loaders. These loaders have been certified by testing and have proven themselves in a variety of practical applications (construction, agriculture, winter maintenance of roads and car parks) in many countries and under different weather and terrain conditions.

Combining years of experience and feedback from our satisfied clients, LOCUST is able to improve on the high-quality components such as engine, hydrostatic drive and construction design, offering high work efficiency and the most favourable price/performance ratio in its class.

The largest loader capable of handling large volumes and weights in the toughest conditions.

LOADER FEATURES

- low operating expenses
- high work efficiency
- easy operation
- high comfort
- unrivalled view from the cabin
- simple servicing and maintenance
- unobstructed accessibility of parts and components
- standard and ISO connection of attachments
- highly flexible and easily manoeuvrable
- a gearbox with gear drives that has proved itself over time by use
- long lifespan



WAY INDUSTRIES, a.s.
Priemyselná 937/4, 963 01 Krupina, SLOVAKIA

Tel: +421 45 5501 402
E-mail: info@way.sk



Locust

L1203

L1203 Speed



DIMENSIONS

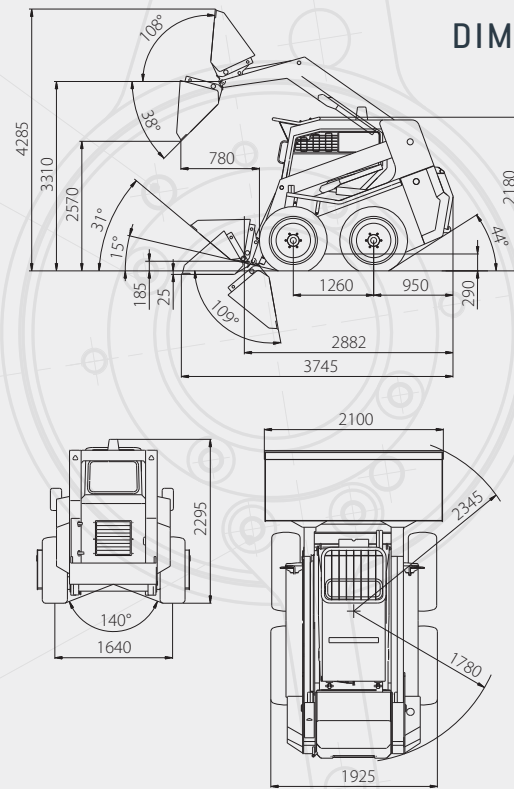

TECHNICAL PARAMETERS

	L 1203	L 1203 SPEED
Loader height	2,180 mm	2,180 mm
Loader length with bucket	3,745 mm	3,745 mm
Loader width with bucket	2,100 mm	2,100 mm
Operating weight	4,300 kg	4,300 kg
Tipping load	1,200 kg	1,200 kg
Maximum speed	12 km/h	10 – 20 km/h
Bucket volume	0.66 m ³	0.66 m ³
Breakout force	30 kN	30 kN
Tractive force	41 kN	44 kN
Lifting force	28 kN	28 kN
Engine type	YANMAR 4TNV 98 T ZNSA 2	YANMAR 4TNV 98 T ZNSA 2
Power	62.5 kW/85 HP	62.5 kW/85 HP
Drive type	hydrostatic	hydrostatic
Hydraulic pump of the working equipment	regulatory – LS/LUDV	regulatory – LS/LUDV
Distributor of working equipment	with closed centre	with closed centre
Bucket balancing	hydraulic	hydraulic
Noise	101 dB	101 dB
Standard tyres	12.5 – 18	12.5 – 18

Authorised business representative



The latest skid steer loader by LOCUST has over 30 years of experience backing it. LOCUST is the direct successor of the loader UNC produced by the same manufacturer with many years of experience, development and tradition combined to make this new loader.



L 1203 TELSPEED

since the first products by UNC were introduced in 1981, the skid steer front loader manufactured in Slovakia has undergone many years of development culminating into today's LOCUST loaders.

These loaders have been certified by testing and have proven themselves in a variety of practical applications (construction, agriculture, winter maintenance of roads and car parks) in many countries and under different weather and terrain conditions.

Combining years of experience and feedback from our satisfied clients, LOCUST is able to improve on the high-quality components such as engine, hydrostatic drive and construction design, offering high work efficiency and the most favourable price/performance ratio in its class.

A loader with a telescopic outrigger with the capability of reaching higher and farther than conventional loaders.

LOADER FEATURES

- low operating expenses
- high work efficiency
- easy operation
- high comfort
- unrivalled view from the cabin
- simple servicing and maintenance
- unobstructed accessibility of parts and components
- standard and ISO connection of attachments
- highly flexible and easily manoeuvrable
- a gearbox with gear drives that has proved itself over time by use
- long lifespan



WAY INDUSTRIES, a.s.
Priemyselná 937/4, 963 01 Krupina, SLOVAKIA

Tel: +421 45 5501 402
E-mail: info@way.sk



Locust

L1203 Telspeed



DIMENSIONS

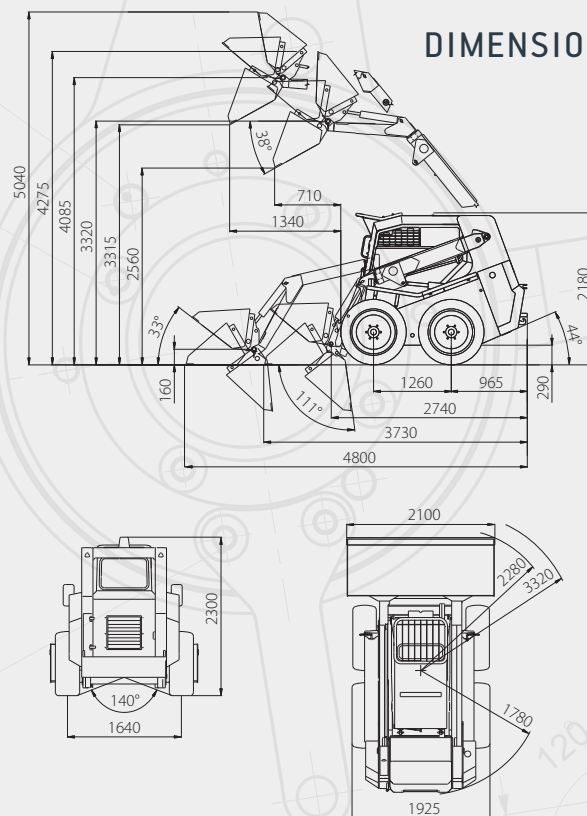

TECHNICAL PARAMETERS

L1203 TELSPEED

Loader height	2,180 mm
Loader length with bucket	3,730 mm
Loader width with bucket	2,100 mm
Operating weight	4,490 kg
Tipping load	600 – 1,200 kg
Maximum speed	10 – 20 km/h
Bucket volume	0.66 m ³
Breakout force	26 kN
Tractive force	44 kN
Lifting force	26 kN
Engine type	YANMAR 4TNV 98 T ZNSA 2
Power	62.5 kW/85 HP
Drive type	hydrostatic
Hydraulic pump of the working equipment	regulatory – LS/LUDV
Distributor of working equipment	with closed centre
Bucket balancing	hydraulic
Noise	101 dB
Standard tyres	12.5 – 18



Authorised business representative