



AUTOSAN

SANCITY 9LE

Low-entry bus intended for city passenger traffic.





CHASSIS

A three-dimensional stainless steel lattice frame integrated with a co-working framework of the body.

Driveline

CUMMINS B4,5E6D210B EURO VI engine, power 151 kW (205 HP).
Automatic transmission with hydraulic retarder.

Axles and wheels

Rear axle: DANA.
Front axle: ZF independent wheel suspension.
Driving wheels: tires 245/70 R19,5.

ECAS kneeling system

Brakes

Service brake: pneumatically controlled, disc-type, with EBS system.
Parking brake: mechanical with spring actuator, acting on rear wheels.

Steering system

Steering gear: with hydraulic power steering.
Steering wheel: regulated position.

Electrical system

24V, negative (-) ground, CAN, KIBES 32 system, batteries: 2 x 220 Ah.

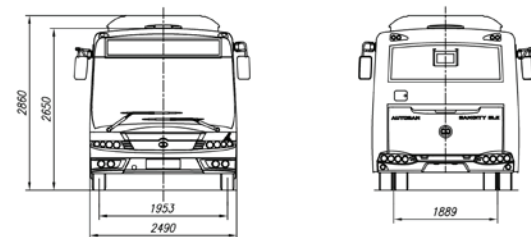
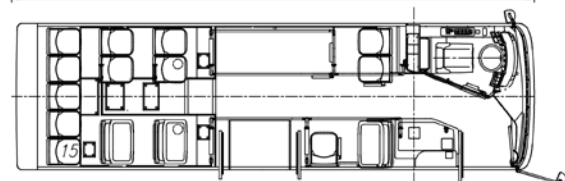
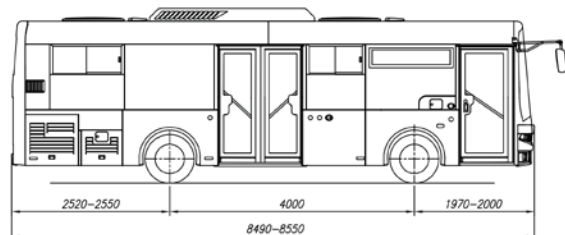
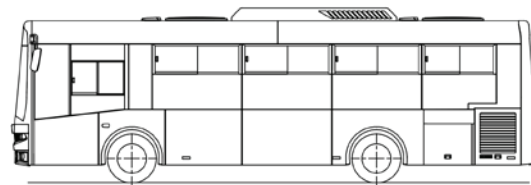

BODY

The construction of the body is made of stainless steel rectangular tubes welded together. The outside paneling made of chrome-nickel sheets (sub-window belt) and GRP panels (front and back walls, roof) bonded to the framework. Side flaps made of aluminum.

Heating

Water heating unit connected to engine's cooling system + convectors + heaters.

Ventilation

Roof hatches and slidable windows, ventilation unit in the front wall and electric fans (exhaust and blowing) in the roof.

Air-conditioning

Passenger doors

Door system 1-2-0. Front single-leaf and middle double-leaf, opening inwards, electro-pneumatically controlled from the driver's working place.

Outside mirrors

Electrically controlled, heated.

INTERIOR

Passenger capacity: seats 15 - 20, standing 41 - 48, total max. 64.
Passenger seats made of plastic with soft upholstery.

Ceiling and sidewalls trimmed with laminated panels, floor covered with a non-skid lining.

Half-closed type driver's cabin with door and FAP console.

Big platform opposite middle door for standing passengers and passenger in a wheelchair.
Manually operated platform for transportation of the disabled person's wheelchair in the middle door.

Handrails powder painted



OPTIONAL EQUIPMENT

- Iveco NEF N45 EURO VI Step D engine, power 137kW (186 HP)
- Air-conditioning of driver's working place
- Driver's seat electrically heated
- Central lubrication system
- Tires pressure and temperature monitoring system
- Automatic detection and fire-fighting system in engine's compartment
- Intelligent speed limiter
- CCTV
- Voice announcement system
- Passenger counting system
- Ticket vending machine
- Cash register stand
- WiFi
- LED destination equipment and ticket punchers set
- Chrome-nickel handrails

* We reserve the right to make changes due to technical progress.

*Photos and drawings from the folder may contain additional items, not included in standard equipment.

Official distributor:

Waryński Trade Sp. z o.o.

ul. Trakt Brzeski 118, 05-077 Warszawa

tel: +48 22 632-11-64

e-mail: kontakt@autosan-distribution.com

www.autosan-distribution.com



WARYŃSKI
Trade Sp. z o.o.